



Flange resilient seat gate valve

i i generation



 Application

 Improvement

 Technical parameter

 Identification





Application

Our flange resilient seat gate valves are used for various systems, such as sewage systems, water systems, industrial systems.



Sewage treatment plants, distribution networks, raw water, digested sewage etc.



Water treatment plants, distribution networks, potable water applications etc.



Chemically contaminated waste water, gas, industrial media, sea water etc.



The handwheel is made of thickened steel board, figure light but stable, durable and hard to be out of shape



Screw from the stainless steel. AISI201 steel and more anti-rust and wear-resisted



Easy to rotate the handwheel, controlling the disc open or shut-off.



Paint thickness $>300\mu\text{m}$



The structure wears
Pressure 2.4 mpa



Face to face dimension by
DIN 3202 F4



The inner hole is smoothly
casted and painted

Stem is made of
stainless steel
AISI420



Stem nut is made of
brass

Complex "AISI420 stem" + "Brass nut"
= Less torque + longer service

There are different options for materials of
stem nut:

- "ductile iron" is more economic;
- "brass" is more durable and anti-rust.





Disc vulcanized
with EPDM,
rubber content
more than 50%.

The flow line of wedged
disc is suitable for
the contour of the
inner chamber.





DESIGN OF TWO COVERS

The square gasket keeps the tightness and good seal between valve's body and cover.



The groove on the cover keeps the gasket from moving or misalignment

Each screw is protected by its rubber cap





Packing gland keeps the tightness and seal between cover and stem



Take off the gland if necessary to replace different sealing O-rings, or move the position retainer to calibrate the position of stem in the disc.



SG45R-16DL 50-600

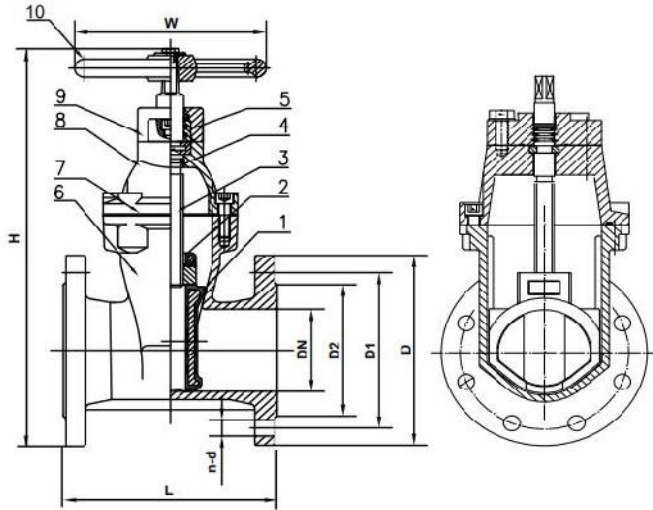

600	390	1260	840	770	722	20-36	640
500	350	1055	715	630	611	20-33	640
400	310	880	580	525	482	16-30	450
350	290	782	520	470	431	16-26	450
300	270	705	460	410	367	12-26	350
250	250	602	405	355	320	12-26	320
200	230	512	340	295	268	12-22	280
150	210	420	285	240	212	8-22	250
125	200	384	250	210	188	8-18	220
100	190	333	220	180	158	8-18	200
80	180	292	200	160	138	8-18	200
65	170	270	185	145	122	4-18	180
50	150	241	165	125	102	4-18	180
DN	L	H	D	D1	D2	n- ϕ d	W

DN (mm)	50-600	
PN (mpa)	1.6	
Working temp.	-10~120 °C	
Working medium	Hot, cold water, steam, gas etc.	
Pressure test	Sealling	1.76
	Strength	2.4

TECHNICAL STANDARDS

1. Design and manufacturing standard: DIN 3352;
2. Flange standard: DIN2632-2633;
3. Face to face standard: DIN 3202 F4;
4. Inspection and testing standard: DIN 3230.

10	Handwheel	Steel					
9	Cover	GGG50					
8	Bonnet	GGG50					
7	Sealing gasket	EPDM					
6	Body	GGG50					
5	O ring	FPDM					
4	O ring	EPDM					
3	Stern	SS420					
2	Stom nut	Brass					
1	Disc	GGG50+EPDM					
NO.	CODE	DETAILS	Qty	MATERIAL	Unit	Total	MEMO
					WEIGHT		
Mark	No.	Charge file No.	Eign	Date	Resilient seated flange gate valve		
Design		Standard		Drawing mark	Weight	Scale	
Correct		Authorized					
Audit		Approved by					
Technic		Date		Total	page	The	page
							SG45R-16DL 50-600



THE DRAWING OF SERIES
SG45R-10/16D DN50-600

DN	WEIGHT/kg	Torque/Hm
50	8	40
65	9	50
80	10	60
100	14	100
125	20	150
150	24	200
200	34	250
250	60	350
300	83	400
350	130	600
400	180	800
500	335	1400
600	470	2500

💡 Torque without extra coefficient

PRESSURE/TEMPERATURE CHART



SUMMARY



Output of production for one month
200 tons/ month



Manufacturing time for 2-4 containers
30 days after getting prepayment



Guarantee period of quality
12 months from the date of installation



Validity of the offer
Prices is valid during 60 days

